

WHY

Build a Dome?

DURABLE AND SECURE

When building a concrete dome you think in centuries, not years, with a lifespan rated in hundreds of years. There's no better way to protect your family and loved ones than with the security a monolithic dome home provides. They are built like a tank, or like you're under a mountain, and they have survived all of these: wildfires, earthquakes, tornadoes, and hurricanes!

FEMA rates monolithic domes as "near-absolute protection" from F5 tornadoes and Category 5 hurricanes. Domes survived a direct hit from Hurricane Katrina in 2005. Other domes survived the 2005 and 2006 wildfires in Oklahoma and Texas.

In 2003, a monolithic dome government building in Iraq survived a direct hit by a 5,000 pound bomb.



AMAZING SAVINGS ON HEATING & COOLING BILLS!

The externally insulated concrete creates a passive solar shell. Overall temperature transfer R value approximates an effective R-70. The dome is seamless and nearly airtight. It is five times more fuel efficient than conventional buildings and with energy costs continuously rising. Some smaller models have even been heated with hair dryers or even candles!

ENERGY EFFICIENT



BEAUTIFUL AESTHETICS

These storybook homes are snuggled in a beautiful wooded rock garden. It's like living in a storybook village right out of the movies!

FREE SPAN INTERIOR

Hundreds of cubic feet with no interfering beams or support posts. The possibilities are endless.

LOW MAINTENANCE

- ✓ No more ice dams or heavy buildup over roof edges!
- ✓ No more leaking roofs!
- ✓ No more worrying about snow loads and shoveling steep roofs!
- ✓ Very little painting needs to be done on exterior.
- ✓ Less risk of damage means lower home insurance costs!

DURABLE & SECURE



A Morningside Storybook Village



SCAN QR FOR MORE INFO

417-779-9000 ext. 327
www.hillsidegardenvillage.com

THE FLOOR PLAN OPTIONS ARE ENDLESS!

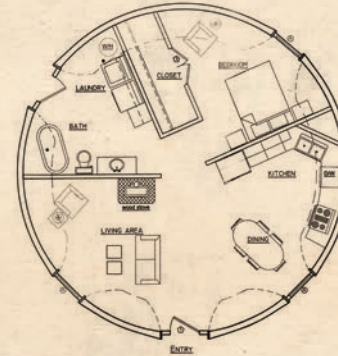
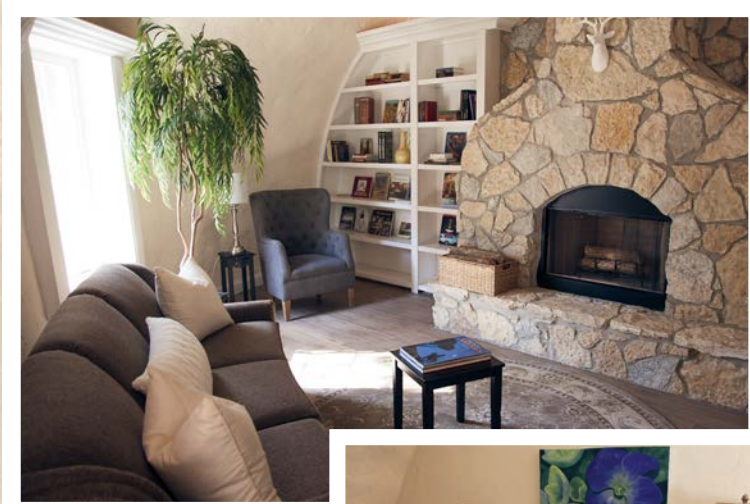

SAMPLE ONE BEDROOM

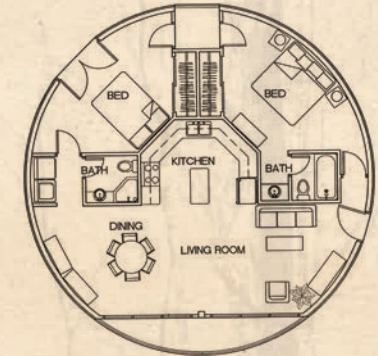

SAMPLE TWO BEDROOMS

PRICING FOR MODELS WITH A PEACE OF MIND

INCLUDED IN BASE PRICE

- Interior Walls
- Loft Plan with 8 ft Interior Walls
- Small Wood Burning Stove

ADDITIONAL UPGRADES

- Enclosed Garage
- Optional Car Port
- Optional View Front or Rear Deck
- Interior Dome Build Out
- Build Out Fireplace

SIZE MODELS:

1 BEDROOM	24 FT 452 SQ. FT. NOW STARTING AT \$140,000!
2 BEDROOM	34 FT 907 SQ. FT. NOW STARTING AT \$155,000!
3 BEDROOM	44 FT 1520 SQ. FT. 3 NOW STARTING AT \$170,000!
4 BEDROOM	54 FT 2290 SQ. FT. NOW STARTING AT \$190,000!

PRICING IS SUBJECT TO CHANGE BASED ON CUSTOMIZATION

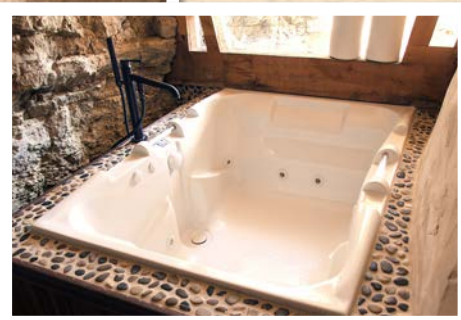
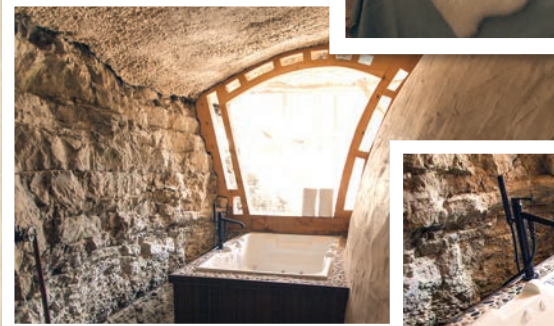

Great Amenities Located in Morningside's Peaceful Valley with access to shower & laundry facilities, Premium Pool and more! Scan QR for more information

LAYOUT SUBJECT TO CHANGE BASE ON CUSTOMER SPECIFICATION (THESE IMAGES ARE FROM THE SPEC HOME ON PROPERTY)